

- NOTES:
- 1 LOCATE FITTINGS FROM PLAN VIEW.
  - 2 TANK(S) MUST BE INSTALLED PER ASSMANN CORPORATION USAGE & GUIDELINES.
  - 3 FLEXIBLE EXPANSION JOINTS MUST BE USED ON ALL SIDEWALL CONNECTIONS.
  - 4 TANKS ARE BUILT PER ASTM D 1998.

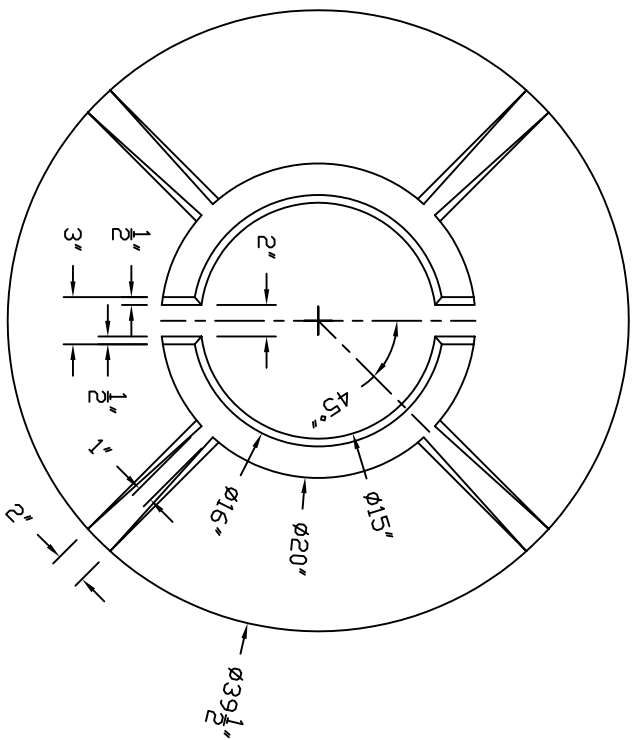
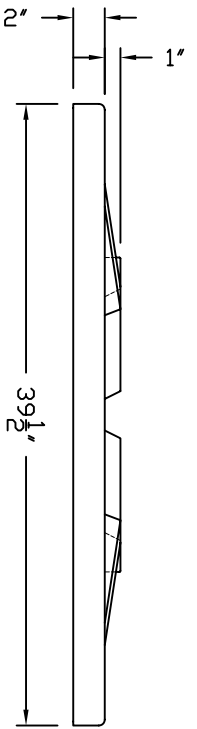

**STIFFENER RIB DETAILS**

ACCESSORIES					
MK	SIZE	DESCRIPTION	DEG	ELEV	DOME
A	-	OPEN TOP COVER	-	-	X

REV	DESCRIPTION	DATE
A	1 ACA REDESIGN OF MOLD, EFFECTIVE AUGUST 2008	2/8/08SR
	REVISION DESCRIPTION	REV DATE

**Assmann**  
CORPORATION OF AMERICA

300 N TAYLOR ROAD  
GARRETT, IN 46728  
PHONE: (260) 337-3181  
FAX: (260) 337-3728

TANK RESISTED SPECIFIC GRAVITY - SP.G. MAX  
TANK WEIGHT - LBS.

TITLE	DOT 210 GALLON CYLINDRICAL OPEN TOP STORAGE TANK
DESIGNED BY	D. MYERS
DATE	2/11/08
SALES ENGINEER	
ASSMANN CORPORATION OF AMERICA	

RESIN USED	
DWG NUMBER	DOT 210
REV	A

ALL DIMENSIONS ARE IN INCHES AND ARE ±3%