

- NOTES:
1. RESIN:
LINEAR MEDIUM DENSITY POLYETHYLENE
 2. CALCULATED CAPACITY:
240 GAL.

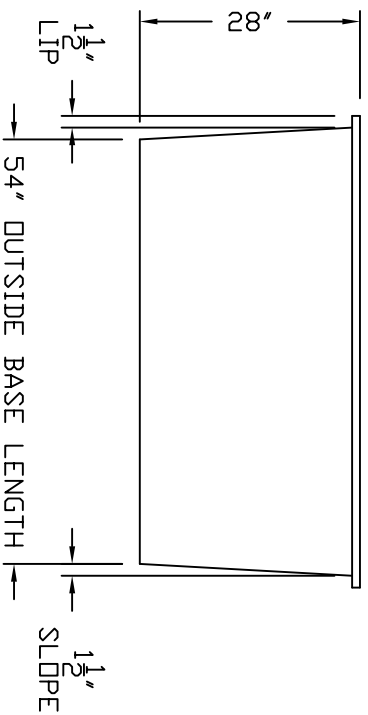
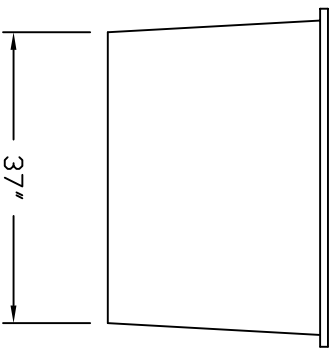
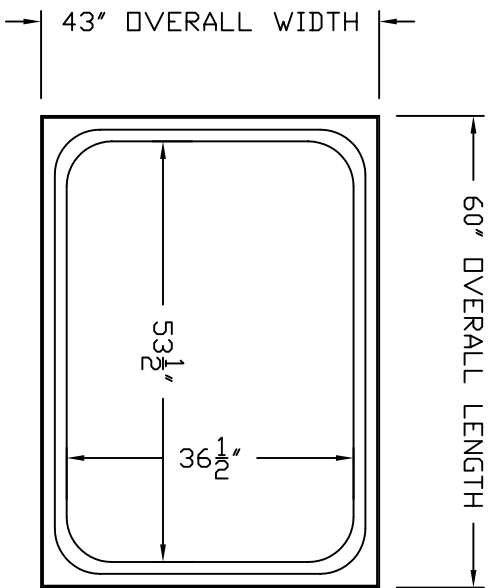

REV	DESCRIPTION	DATE
A	UPDATED TITLE BLOCK	2/17/09 MG

Assmann
CORPORATION OF AMERICA

300 N TAYLOR ROAD
GARRETT, IN 46738
PHONE: (260) 357-3181
FAX: (260) 357-3738

TITLE ASSMANN CORPORATION 240 GAL.
CONTAINMENT BASIN

DRAWN BY: D. MYERS
DRAWN DATE: 8/19/05

DWG NUMBER: IRD 240

REV: A